

## 86 CAMPUS AVE FIELD – NEW BLEACHERS

### NEW CONSTRUCTION

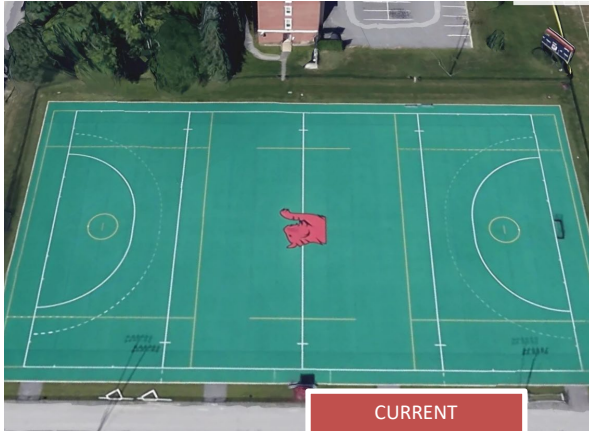

CURRENT

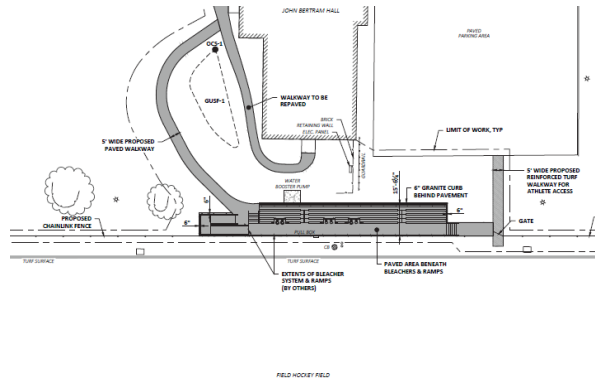

PROPOSED

<b>BLEACHERS</b>	A+ Athletic Products, Rollinsford, NH
<b>ENGINEER</b>	Wright-Pierce, Topsham ME
<b>SITE CONTRACTOR</b>	St. Laurent & Son, Lewiston, ME
<b>COMPLETION DATE</b>	Summer 2022
<b>PROGRAMMATIC DRIVER</b>	Spectator Seating Needed
<b>PROJECT DESCRIPTION</b>	Accessible bleachers for 256 spectators are being added to the west side of the field next to John Bertram Hall. The walkway running from the corner of Campus Ave and Central Ave to the bleachers is being reworked to be accessible.